

With Panel

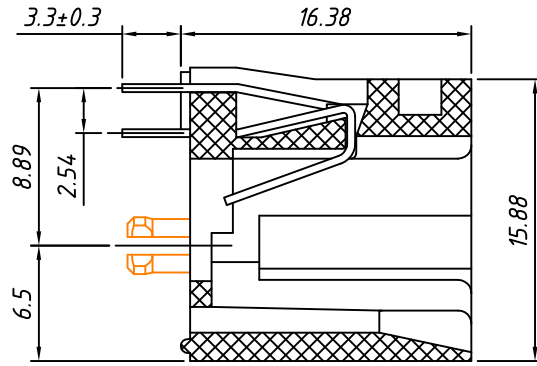

SECTION A-A

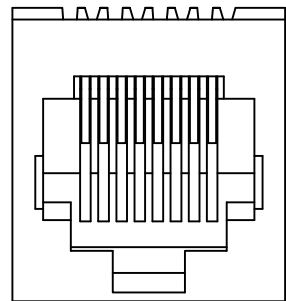
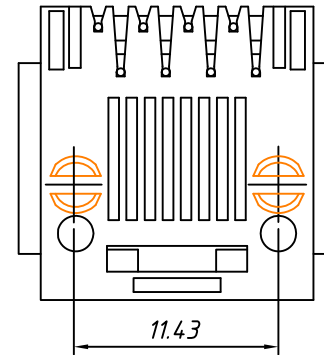

Without Panel

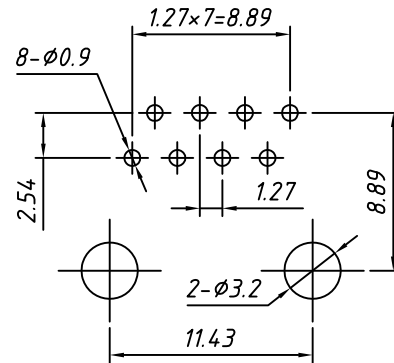

PCB Layout

Material:
 Housing: PBT+Glass Filled Polyester
 Flammability Rating : UL94V-0
 Contacts: Phosphor Bronze ϕ 0.46mm
 Plating: Gold Plating

Electrical:
 Voltage Rating: 125VAC
 Current Rating: 1.5A
 Contact Resistance: 30m Ω Max.
 Insulation Resistance: 500M Ω Min.
 Dielectric Strength: 1000VAC Rms 50Hz,1 Min.
 Durability: 600 cycles Min.
 Operation Temperature:-40°C~+70°C

Order Information

L-KLS12-156-8P8C-X-X-1-XX

RoHS
 Contacts: 8P8C
 Panel Code: W-with Panel
 W/O-without Panel
 Peg Code: L-L Peg S-Split Peg
 Color Code: 1-Black
 Plating Code:
 01-Fu" Gold Plating
 02-3u" Gold Plating
 03-6u" Gold Plating
 04-15u" Gold Plating
 05-30u" Gold Plating

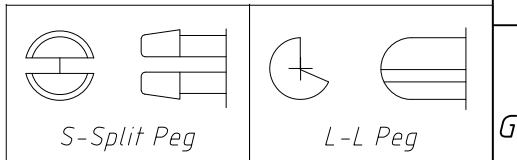

GENERAL TOLERANCE	PROJECTION		Description:
X. ±0.30	UNITS	mm	RJ45-8P8C Vertical Modular jacks,Black KLS P/N: L-KLS12-156-8P8C-X-X-1-XX
.X ±0.25	SCALE	1:1	
.XX ±0.20	Draw by:	Jenny	
ANGLE TOLERANCE	Check by:	Daniel	NingBo KLS ELECTRONIC CO.,LTD.
X. ±3°	Date	2019-12-26	
.X ±2°	SHEET	1 OF 1	
.XX ±1°			